

400mm Single Bowl Sink

1.2mm Thickness | Stainless Steel

304
Stainless
Steel

10
Year
Warranty



COLOURS



Stainless Steel: BDSF4410X

Gun Metal: BDSF4410GM | Rose Gold: BDSF4410RG

PRODUCT FEATURES

BUILT TO ENDURE

Premium 1.2mm thick, 304 Grade Stainless Steel creates a surface highly resistant to stains, rust and corrosion.

SOUND ABSORPTION

Noise suppression pads are applied to all external areas of the sink to dampen water impact noise during use.

THOUGHTFULLY DESIGNED

A rear waste results in less pipe intrusion into the cupboards underneath allowing for more storage space, while a 10mm corner radius and folded drainage points limit build up in the sink to ensure easy cleaning.

AVAILABLE ACCESSORIES



Chopping Board
Model Code: BDCB30K



Rollermat
Model Code: BDRM40X



TOPMOUNT



FLUSHMOUNT



UNDERMOUNT



HIDDEN
OVERFLOW



NOISE
SUPPRESSION



REAR
WASTE



CORNER
RADIUS

Specifications, Dimensions and Installation

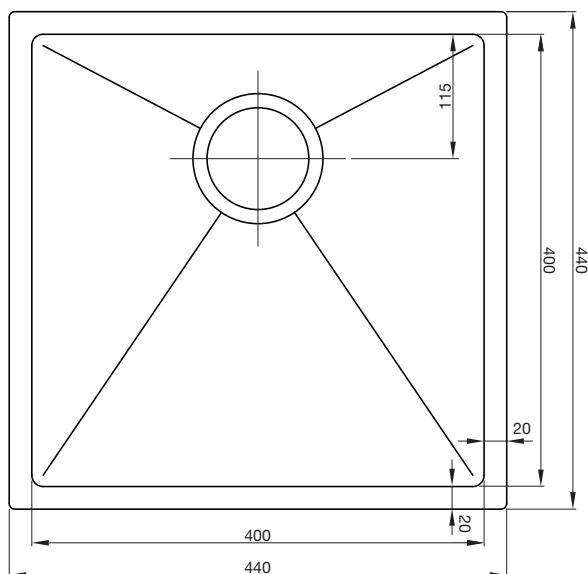

FEATURES	
Corner Radius (mm)	10
No. of Waste Outlets	1
Hidden Overflow	Yes
Drainer	No
Material	304 Grade / 1.2mm Thick Stainless Steel
Finish	Stainless Steel
ACCESSORIES	
Chopping Board	Optional
Rollermat	Optional
INSTALLATION	
Installation Type	Topmount / Flushmount / Undermount
Cut-Out	Refer to Template
Cabinet Base (mm)	500 min.
DIMENSIONS (PACKED)	
Width x Height x Depth (mm)	495 x 265 x 495
Gross Weight (kg)	7.4
DIMENSIONS (PRODUCT)	
Width x Height x Depth (mm)	440 x 210 x 440
Net Weight (kg)	4.7
DIMENSIONS (BOWL)	
Width x Height x Depth (mm)	400 x 200 x 400
WARRANTY	
Parts & Labour	1 Year*
Replacement	10 Years*

*Terms and Conditions apply



Scan for more info