

400mm Single Bowl Sink

1.2mm Thickness | Gun Metal Finish

304
Stainless Steel

10
Year Warranty



COLOURS



Gun Metal: BDSF4410GM
Stainless Steel: BDSF4410X | Rose Gold: BDSF4410RG

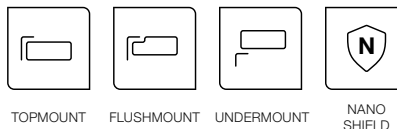

TOPMOUNT FLUSHMOUNT UNDERMOUNT NANO SHIELD



PVD COATING HIDDEN OVERFLOW NOISE SUPPRESSION REAR WASTE CORNER RADIUS

PRODUCT FEATURES

BUILT TO ENDURE

Premium 1.2mm thick, 304 Grade Stainless Steel creates a surface highly resistant to stains, rust and corrosion.

SOUND ABSORPTION

Noise suppression pads are applied to all external areas of the sink to dampen water impact noise during use.

THOUGHTFULLY DESIGNED

A rear waste results in less pipe intrusion into the cupboards underneath allowing for more storage space, while a 10mm corner radius and folded drainage points limit build up in the sink to ensure easy cleaning.

COLOUR AND PROTECTION

A special PVD coating provides the sink with its distinctive colour and a NANO SHIELD coating increases durability and aids in prolonging the finish.

AVAILABLE ACCESSORIES

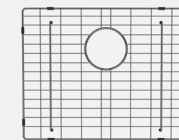

Protective Grid
(Included)



Chopping Board
Model Code: BDCB30K



Roller mat
Model Code: BDRM40X

Specifications, Dimensions and Installation

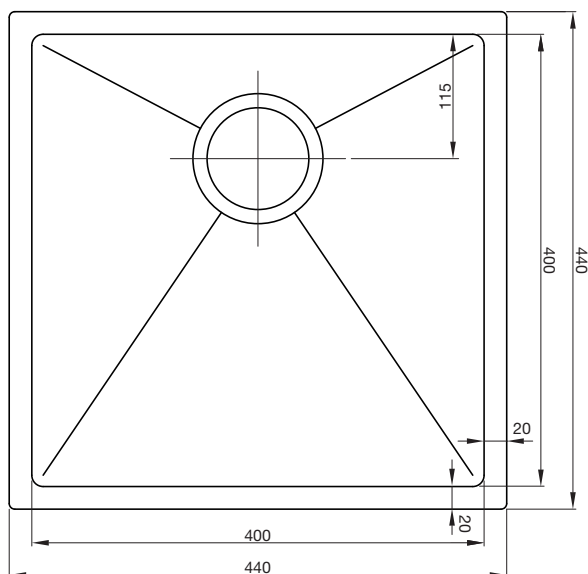

FEATURES	
Corner Radius (mm)	10
No. of Waste Outlets	1
Hidden Overflow	Yes
Drainer	No
Material	304 Grade / 1.2mm Thick Stainless Steel
Finish	Gun Metal
ACCESSORIES	
Protective Grid	Included (x1)
Chopping Board	Optional
Rollermat	Optional
INSTALLATION	
Installation Type	Topmount / Flushmount / Undermount
Cut-Out	Refer to Template
Cabinet Base (mm)	500 min.
DIMENSIONS (PACKED)	
Width x Height x Depth (mm)	495 x 265 x 495
Gross Weight (kg)	7.4
DIMENSIONS (PRODUCT)	
Width x Height x Depth (mm)	440 x 210 x 440
Net Weight (kg)	4.7
DIMENSIONS (BOWL)	
Width x Height x Depth (mm)	400 x 200 x 400
WARRANTY	
Parts & Labour	1 Year*
Replacement	10 Years*

*Terms and Conditions apply



Scan for more info